



VIDACASA®
by **AMERICAN METALCRAFT**

VIDACASA® BY AMERICAN METALCRAFT

Vidacasa by American Metalcraft is the first temperature-controlled buffetware that works independently of electricity, cords, gels, fire or ice. It was developed for chefs and caterers who need modern, safe and efficient ways to keep food hot or cold, indoors or outside. Designed for buffet presentations, Vidacasa features a variety of modular bases, plates and accessories. Each piece in the line can accept both iThermo Hot and Cold Cells for consistent food temperatures.

THE COMBINATIONS ARE ENDLESS...

Completely modular, Vidacasa includes components that can mix and match with one another quickly to change up buffets. You can easily change from cold appetizers to hot entrees to cold desserts. With different iThermo cells, you can serve hot and cold food in the same buffet line. Mix in other American Metalcraft platters, bowls and casseroles and you can update buffet lines in minutes!

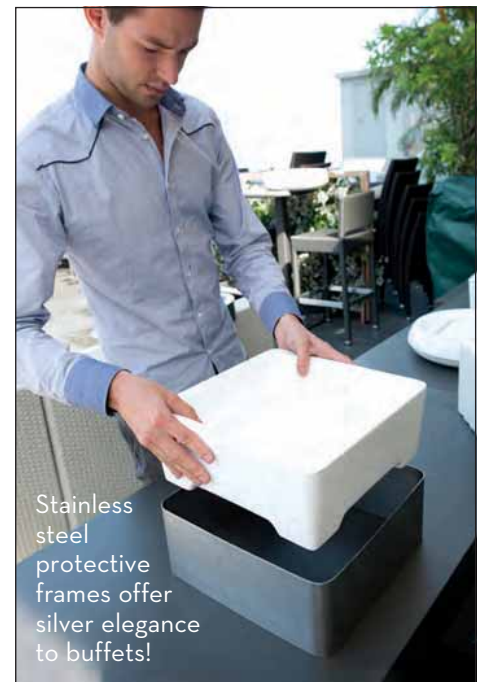
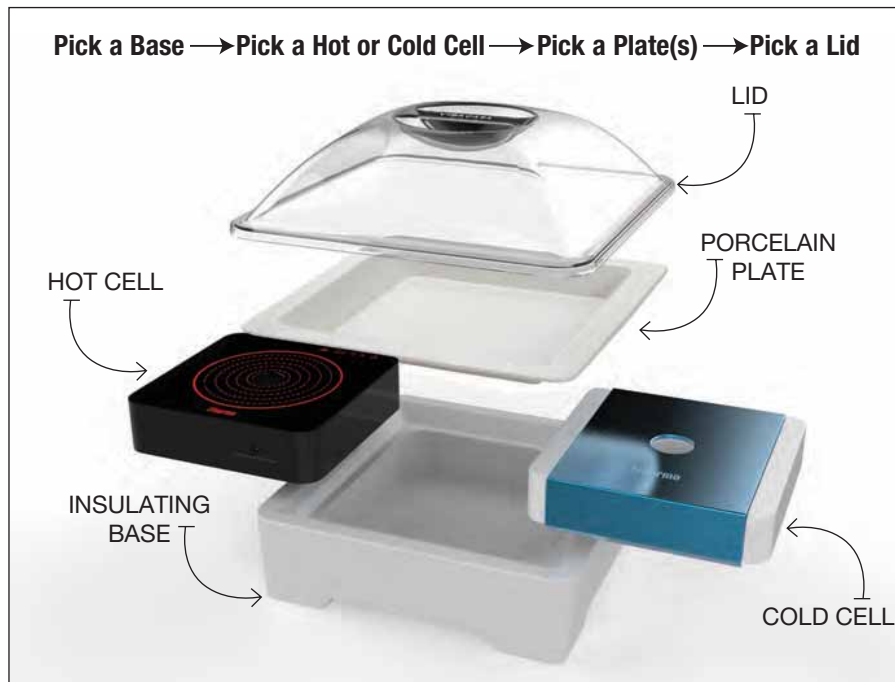

COLD TECHNOLOGY

Keep food colder longer with Vidacasa Cold Cells! Developed for NASA to help keep astronauts at a constant temperature during space walks, the cooling technology is conducted through the flat surfaces of the Cold Cells, efficiently chilling food.

Vidacasa Cold Cells far outperform wet ice, blue gel and ice packs. They are ideal for presenting chilled food ranging from salads and cold appetizers to cool desserts. Cold Cell contents are non-toxic, food-safe and comply with USA, BS EN and FDA standard tests.

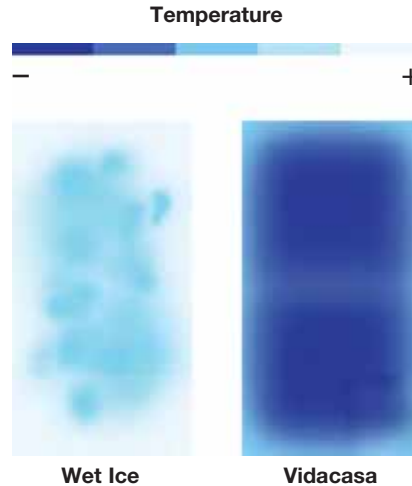
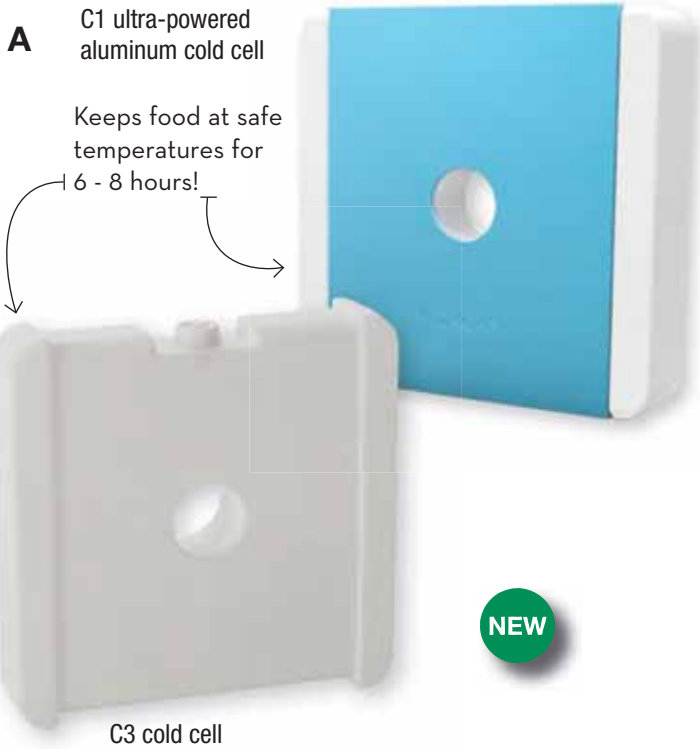

Recharge Cold Cells:

- Recharge in 0° F (-18° C) freezer
- Recharge time: 24 hours
- Each cell can be recharged up to 1,200 times

A) Vidacasa iThermo® Cold Cells

- Cold Cells deliver a constant temperature of 14° F (-10° C)
- Cells maintain temperature for up to 8 hours
- Recharge cells for 24 hours in a 0° F (-18° C) freezer
- Cold Cells can be used inside Vidacasa bases, in party tubs and pails to keep food and beverages cold

Deliver constant temperature



Put in freezer to recharge
0° F -18° C 24 hr
 up to 1,200 times

Item No.	Description	Pack	Cu. Ft.	Wt.	List Price
C3	iThermo Cold Cell 8 7/8" L x 7 3/4" W x 1 5/8" H (21.9 x 19.7 x 4.1 cm)	6	0.69	20	48.00 Ea
C1	Ultra-Powered Aluminum Cold Cell 8" Sq. x 2" H (20.3 x 5.1 cm)	6	0.50	20	76.00 Ea
2174PAD*	Pad (not shown) 7 5/8" L x 7 1/4" W x 1/4" H (19.4 x 18.4 x 0.6 cm)				44.00 Pk Pack of 10

*For best results, a pad may be required to insure surface-to-surface contact between cell and serving vessel.

NOTE: The performance of the VIDACASA Cold Cell will not directly correlate to the temperatures of food on the plate surface, due to the density of food types, indoor / outdoor elements and other external variables. On average, while using wet ice, food will only stay at a constant temperature of 41°F (5°C) or below for 8 minutes. With the VIDACASA C1 and C3, food will stay at a constant temp of 41°F (5°C) or below for 132 minutes. Full test results are available upon request.

Traditional Solutions	Vidacasa Solution
Wet ice / dry ice / blue gel with normal plate	Vidacasa Cold Cell Buffetware
Unsophisticated presentation	Elegant presentation
Poor performance	Outstanding cooling performance
Not reusable	Reusable, eco-friendly
Dry ice is dangerous and toxic	Food-safe and non-toxic

HOT TECHNOLOGY



Eliminate open flames and diminish the risk of fire with Vidacasa! Unlike induction heat, Vidacasa Pro Hot Cells are cordless and portable, making buffet presentations extremely flexible. The design is perfect for serving a variety of dishes, large or small, to any sized event.

Unique thermal engines are at the heart of the Vidacasa system, providing maximum transformation of electricity to heat. The heat energy is conducted through the flat surface of Hot Cells, ensuring food stays warm efficiently and evenly.

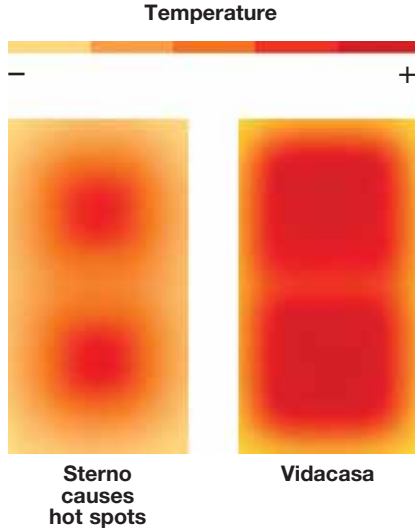

A



HOT CELL-ER

H1 pro hot cell

Keeps food at optimal heat for up to 3 hours!

Recharge Hot Cells:

Direct Wall Mount Charging

6 Hours

- Recharge time: 6 hours
- Each cell can be recharged up to 500 times

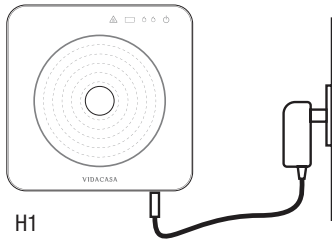

176°F 80°C	230°F 110°C	Plug-in Recharge
3 hr	2 hr	6 hr
∞ w/ Cord		

Traditional Solutions

Sternos / Chafing Fuel
Placed outside the plates, visible presentation
Fire hazard
Inconsistent performance
Not reusable

Vidacasa Solution



Vidacasa Hot Cell Buffetware
Placed inside the base tray, elegant presentation
Flexible and safe to use
Excellent warming performance up to 3 hours*
Portable, reusable, safe and eco-friendly

A) Vidacasa iThermo® Pro Hot Cell



- Depending on the setting, the Hot Cell will deliver constant temperatures of 176° F (80° C) or 230° F (110° C)
- Cordless performance of up to 3 hours. Cell can be used with charger for continuous heat
- Recharge cell by connecting directly to a wall outlet (charger included)
- Hot Cells can be used inside Vidacasa bases, with chafers and griddles to keep food at optimal temperatures

Item No.	Description	Pack	Cu. Ft.	Wt.	List Price
H1	Pro Hot Cell 8" Sq. x 2" H (20.3 x 5.1 cm)	6	2.24	31	520.00 Ea

*Cordless performance of up to 3 hours. Cell can be used with charger for continuous heat.

CONVENIENT STORAGE AND EASY TRANSPORT!

Save time and energy with Vidacasa Charging Stations by American Metalcraft! Cut down on the amount of time spent charging multiple units and energy consumed with multiple outlets. Available in two sizes, these charging stations are equipped to recharge multiple Hot Cells at a time. Each station is designed with standard 15 Amp electrical circuits that help the system evaluate the amount of electrical currents that can be drawn.

Off-premise operations also get a little easier with our insulated bag for Hot and Cold Cells. This lightweight, insulated bag features a convenient carrying strap. Load up six Hot Cells or six Cold Cells in each bag and hit the road!

B) Wall-Mounted Charging Station

- Power strip mounted in upper compartment provides power for up to 8 Hot Cells
- Retractable door moves completely out of the way, providing easy access to cells
- Torque-resistant lock acts as a handle when supplied combination padlock is removed
- Mounting bracket and through holes provide the ability to secure station to either a wall or surface
- Ships fully assembled and ready to use
- Warranty: Body - 12 year, Electrical - 1 year

Item No.	Description	Pack	Cu. Ft.	Wt.	List Price
CAB8	(8) Cell Charging Station 28¾" L x 15" W x 14¼" H (73 x 38.1 x 37.5 cm)	1	6.11	80	2,140.00 Ea



C) Charging Station

- Provides power for up to 20 Hot Cells with laser printed numbers on every slot for identification
- Includes a sophisticated power manager that continuously analyzes power equipment to prevent circuit tripping
- Side panel includes a cord winder to keep the power cord neat and out of the way when not in use, as well as additional accessory hooks
- Full-access doors in the front with removable panel in the back of cart for access to power
- Power manager features temperature sensors that control two cooling fans, keeping Hot Cells at a safe operation condition
- Dual-handle design for safe and easy mobility
- Ships fully assembled and ready to use
- Warranty: Body - 12 year, Electrical - 1 year

Item No.	Description	Pack	Cu. Ft.	Wt.	List Price
CART20	(20) Cell Charging Station 34½" L x 25" W x 43" H (87.7 x 63.5 x 109.2 cm)	1	29.07	190	4,800.00 Ea



D) Insulated Bag for Hot and Cold Cells

With six individual slots, this handy insulated carrying bag holds six Hot Cells or six Cold Cells.

Item No.	Description	Pack	Cu. Ft.	Wt.	List Price
VB6	12¾" L x 9" W x 10¼" H (32.4 x 22.9 x 26 cm)	4	3.05	9	76.00 Ea



RECTANGULAR BUFFETWARE

A C605BASE shown with (2) C305SP square plates and 1782AB adapter bar

C605BASE shown with A605T frame and C605TP rectangular plate



Heritage Bacon & Eggs

Creme Brulee French Toast

Use the adapter bar for multiple plates!

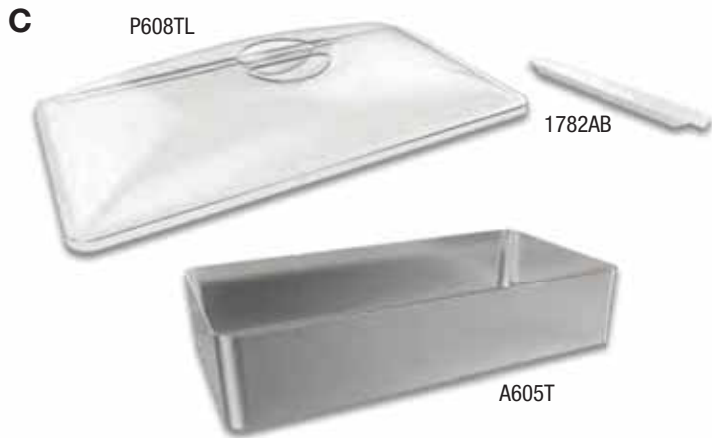

WSBAL shown with C605BASE and two C1 cold cells

A) Rectangular Base

Item No.	Description	Pack	Cu. Ft.	Wt.	List Price
C605BASE	Base 24" L x 12" W x 5" H (61 x 30.5 x 12.7 cm)	2	3.22	18	290.00 Ea

B) Rectangular Plates

Item No.	Description	Pack	Cu. Ft.	Wt.	List Price
C305SP	64 oz. (1.9 L) Square Porcelain Plate (1/2 Size) 12" Sq. x 2" H (30.5 x 5.1 cm)	4	1.73	22	60.00 Ea
C605TP	164 oz. (4.9 L) Rectangular Porcelain Plate (Full Size) 24" L x 12" W x 2" H (61 x 30.5 x 5.1 cm)	3	2.66	42	130.00 Ea

C) Rectangular Buffetware Accessories

Item No.	Description	Pack	Cu. Ft.	Wt.	List Price
P608TL	Rectangular Lid 25" L x 13" W x 4" H (63.5 x 33 x 10.2 cm)	10	2.41	20	46.00 Ea
1782AB	Adapter Bar* 11" L x 1" W x 1/2" H (27.9 x 2.5 x 1.3 cm)	60	0.99	5	30.00 Ea
WSBAL	Bamboo Frame 25 1/8" L x 13 1/8" W x 5 1/4" H (63.8 x 33.3 x 13.3 cm)	2	2.48	11	80.00 Ea
A605T	Stainless Steel Frame 24 1/4" L x 12" W x 4 3/4" H (61.6 x 30.5 x 12.1 cm)	4	5.90	33	180.00 Ea

*Adapter Bar needed for use of multiple plates on one base.

C281BASE shown with C281SP flat square plate

HOT SELLER



C305BASE shown with C305SP deep square plate

D) Square Bases



Item No.	Description	Pack	Cu. Ft.	Wt.	List Price
C281BASE	Flat Base 11½" Sq. x 3" H (29.2 x 7.6 cm)	2	3.22	18	90.00 Ea
C305BASE	Deep Base 12" Sq. x 5" H (30.5 x 12.7 cm)	2	3.22	18	150.00 Ea

E) Square Plates

Item No.	Description	Pack	Cu. Ft.	Wt.	List Price
C281SP	Flat Square Porcelain Plate 11" Sq. x ¾" H (27.9 x 1 cm)	8	1.14	20	54.00 Ea
C305SP	64 oz. (1.9 L) Deep Square Porcelain Plate 12" Sq. x 2" H (30.5 x 5.1 cm)	3	0.80	15	60.00 Ea

F) Square Buffetware Accessories

Shallow Accessories

Item No.	Description	Pack	Cu. Ft.	Wt.	List Price
P2811SL	Flat Square Lid 11½" Sq. x 3" H (29.2 x 7.6 cm)	10	0.81	13	55.00 Ea
WSBAS	Bamboo Frame 14" Sq. x 5¼" H (35.6 x 13.3 cm)	4	2.63	20	72.00 Ea
A281S	Flat Stainless Steel Frame 11" Sq. x 1½" H (27.9 x 3.8 cm)	24	4.00	58	160.00 Ea

Deep Accessories

Item No.	Description	Pack	Cu. Ft.	Wt.	List Price
P308SL	Deep Square Lid 13" Sq. x 4" H (33 x 10.2 cm)	10	1.19	11	33.00 Ea
A305S	Deep Stainless Steel Frame 12¾" Sq. x 4¾" H (31.4 x 12.1 cm)	4	2.44	22	170.00 Ea

E & F



F

NEW



WSBAS shown with C305BASE and H1 pro hot cell

A



SBHL shown with two H1 pro hot cells

SBHS shown with one C1 cold cell

A



SBL shown with two H1 pro hot cells and CILO14 oval cast iron pan

SBS shown with one C1 cold cell

A



HMCL shown with two H1 pro hot cells, CILO12 oval cast iron pan and CIS10 cast iron fry pan

HMCL

HMCS

A) Stainless Steel Crates

Six different styles are available in these stainless steel crates that are designed to hold one or two Vidacasa Cells. They really dress up the table!

Hammered Solid Crates

Item No.	Description	Pack	Cu. Ft.	Wt.	List Price
SBHS	9 1/8" Sq. x 2 1/2" H (23.2 x 6.4 cm) Fits 1 Vidacasa Hot or Cold Cell	4	0.85	21	82.00 Ea
SBHL	17 1/4" L x 9 1/2" W x 2 1/2" H (43.8 x 24.1 x 6.4 cm) Fits 2 Vidacasa Hot or Cold Cells	2	0.94	19	139.00 Ea

Satin Solid Crates

Item No.	Description	Pack	Cu. Ft.	Wt.	List Price
SBS	9 1/8" Sq. x 2 1/2" H (23.2 x 6.4 cm) Fits 1 Vidacasa Hot or Cold Cell	4	0.85	21	77.00 Ea
SBL	17 1/4" L x 9 1/2" W x 2 1/2" H (43.8 x 24.1 x 6.4 cm) Fits 2 Vidacasa Hot or Cold Cells	2	0.94	19	130.00 Ea

Hammered Frame Crates

Item No.	Description	Pack	Cu. Ft.	Wt.	List Price
HMCS	9 1/8" Sq. x 2 1/2" H (23.2 x 6.4 cm) Fits 1 Vidacasa H1 Hot or Cold Cell	6	0.86	20	58.00 Ea
HMCL	17 1/4" L x 9 1/2" W x 2 1/2" H (43.8 x 24.1 x 6.4 cm) Fits 2 Vidacasa H1 Hot or Cold Cells	4	1.13	24	94.00 Ea

Fit one or two hot cells in these stainless steel and wood crates for a completely different look



H1 Pro Hot Cell

B) Wood Crates



Wood crates hold one or two Hot Cells depending upon size.

Bamboo

Item No.	Description	Pack	Cu. Ft.	Wt.	List Price
WCBS	9 1/8" Sq. x 2 1/2" H (23.2 x 6.4 cm) Fits 1 Vidacasa Hot Cell	24	1.62	26	37.00 Ea
WCBL	17 1/4" L x 9 1/2" W x 2 1/2" H (43.8 x 24.1 x 6.4 cm) Fits 2 Vidacasa Hot Cells	12	3.40	29	47.00 Ea

Black

Item No.	Description	Pack	Cu. Ft.	Wt.	List Price
WBLS	9 1/8" Sq. x 2 1/2" H (23.2 x 6.4 cm) Fits 1 Vidacasa Hot Cell	24	1.62	26	31.00 Ea
WBLL	17 1/4" L x 9 1/2" W x 2 1/2" H (43.8 x 24.1 x 6.4 cm) Fits 2 Vidacasa Hot Cells	12	3.40	29	43.00 Ea

Natural

Item No.	Description	Pack	Cu. Ft.	Wt.	List Price
WCNS	9 1/8" Sq. x 2 1/2" H (23.2 x 6.4 cm) Fits 1 Vidacasa Hot Cell	24	1.62	26	31.00 Ea
WCNL	17 1/4" L x 9 1/2" W x 2 1/2" H (43.8 x 24.1 x 6.4 cm) Fits 2 Vidacasa Hot Cells	12	3.40	29	43.00 Ea

Vintage

Item No.	Description	Pack	Cu. Ft.	Wt.	List Price
WCVS	9 1/8" Sq. x 2 1/2" H (23.2 x 6.4 cm) Fits 1 Vidacasa Hot Cell	24	1.62	26	29.00 Ea
WCVL	17 1/4" L x 9 1/2" W x 2 1/2" H (43.8 x 24.1 x 6.4 cm) Fits 2 Vidacasa Hot Cells	12	3.40	29	41.00 Ea

C) Rectangular Porcelain Platter

Item No.	Description	Pack	Cu. Ft.	Wt.	List Price
C46TP	17 3/8" L x 9" W x 1/4" H (44.1 x 22.9 x 0.6 cm)	4	0.56	18	94.00 Ea

D) Porcelain Bowls

Item No.	Description	Pack	Cu. Ft.	Wt.	List Price
POR9	72 oz. (2.1 L) Square 9 3/4" Sq. x 2 3/4" H (24.8 x 7 cm)	6	2.49	24	48.00 Ea
POR17	144 oz. (4.3 L) Rectangular 17 3/4" L x 9 3/4" W x 2 3/4" H (45.1 x 24.8 x 7 cm)	4	2.79	26	138.00 Ea



Four different finishes!

Shown with three H1 pro hot cells



POR17 shown with WBLL crate and two H1 pro hot cells

POR9 shown with WBLS crate and two H1 pro hot cells